

SONORA™

MODEL # 2004B

BOTTOM DRAIN WATERLESS URINAL



**EcoTrap®
Inside!**



APPLICATION

- Commercial and Residential Use

FURNISHED WITH

- Two unit integrated wall hangers
- Fastening hardware
- **Two EcoTraps®**, vertical trap design

NOTE:

- Adequate BlueSeal® trap liquid to be provided for EcoTrap® of urinal, not furnished.

COLORS

Standard white; other colors available

WARRANTY

3 Year Limited Warranty.



WATERLESS CO. INC. 800.244.6364

In keeping with our policy of product improvement, Waterless Co. reserves the right to change product specifications at any time without notice. It is the responsibility of the specifier, installer and wholesale seller to confirm specification at time of sale or installation. No responsibility is assumed, claimed or accepted by Waterless Co. Inc.

DESCRIPTION

Waterless Co. Inc. No-Flush™ urinal Model #2004 Sonora™ Bottom Drain, wall hung, made of High Performance Composite material (HPC) **for commercial and residential use.** Urinal to have elongated rim, a full 2" interior drain and 2" flanged waste outlet; suitable for direct connection to a 2" waste at the wall. Supplied EcoTrap® insert required. Trap insert to be of a vertical flow type with 360 degree perimeter openings and installed by press fit. Trap must be replaceable and refillable. Trap inserts are to be removed with a two pronged heavy duty stainless steel tool. Urinal to be fastened at the bottom front using standard bolts from brass urinal flange. The bottom of the urinal is to be fully enclosed.

DIMENSIONS (WxHxD)

18.0 x 28.0 x 14.0 inches (457 x 711 x 356 mm)

APPROX. WEIGHT

22 lbs (10 kg)

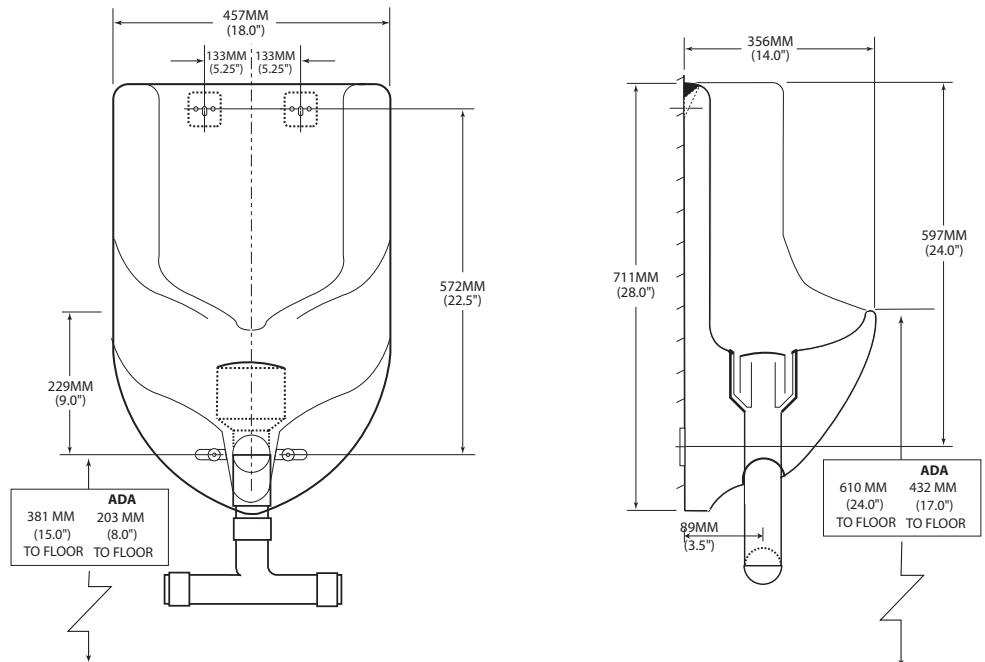

CODES/STANDARDS APPLICABLE: Complies w/ A117, ASME A112.19.19, Z124.9 others.

FOR STANDARD INSTALLATION: mount at 24" above finished floor to lip of urinal or as required by architect. Center drain line to be determined by installer.



FOR ADA REQUIREMENTS: mount at 17" above finished floor to lip of urinal. Center drain line to be determined by installer.

Supply suitable wall support, i.e. carrier. Install and maintain as per manufacturer's instructions. Urinal 2" drain outlet installs and drains to 2" waste. Retrofit or new construction. Use standard sanitation practices to maintain fixture.

NOTE ON INSTALLATION:

Installation requires purchase of standard ABS 2" drain parts and wall screws plus washers for attachment at bottom, not included.

For startup of urinal, purchase 1 x 6009 iPack. Good for up to 5 urinals.
(Includes: 1 x 1114 BlueSeal®, 1 x 4002 PortionAid and 1 x 4001 Xtraptor Tool)



WATERLESS
the innovative brand since 1991